

ABERNATHY and ASSOCIATES

Kenneth B. Abernathy Jr.

Wisconsin Registered Land Surveyor

S-1594

W4056 BRAY RD.

ELKHORN, WI. 53121

PHONE: (262) 723-4260 (OFFICE)

(262) 723-7209 (FAX)

Email: abernathy@elknet.net

Plat of Survey

Lots 34 and Lot 35 of Baywood Estates
1st Addition located in the NW 1/4
of Section 1 and the NE 1/4 of Section 2
Town 3 North, Range 16 East, Walworth County, Wisconsin

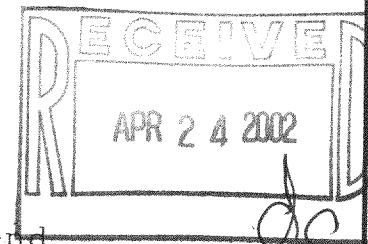

Legend

- Ø FOUND IRON PIPE
- FOUND IRON ROD
- ⊠ FOUND BRASS CAPPED MONUMENT
- FOUND CONCRETE MONUMENT
- + CHISEL CUT IN CONCRETE
- SET IRON ROD, 24" LONG, WEIGHING 1.5 LBS./LINEAL FT., 3/4" DIA.
- SET IRON ROD, 30" LONG, WEIGHING 4.5 LBS./LINEAL FT., 1-11/16" DIA.
- (x x) RECORDED AS DIMENSION
- x — EXISTING FENCE

Bearings are based
on previous surveys
of record

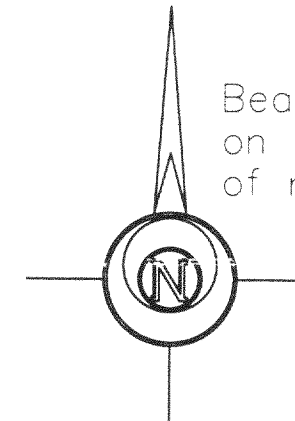

SCALE: 1" = 50 FEET

Owners: Ian and Mary Greeley
W5333 Briarwood Rd.
Elkhorn, WI. 53121

Legal Description for Easement

An easement six feet wide by fifty feet long to provide minimum setback distance from an existing deck of Lot 34. Commence at the Northeast Corner of Lot 35 of Baywood Estates 1ST Addition, located in the NW 1/4 of Section 1 and the NE 1/4 of Section 2, Town 3 North, Range 16 East, Walworth County, Wisconsin; thence S 10 deg 38 min 18 sec W along the easterly line of said lot 60.00 feet to the point of beginning; thence continue S 10 deg 38 min 18 sec W along said easterly line 50.00 feet; thence N 79 deg 21 min 42 sec W 6.00 feet; thence N 10 deg 38 min 18 sec E 50.00 feet; thence S 79 deg 21 min 42 sec E 6.00 feet to the point of beginning.

"I hereby certify that the above described property has been surveyed by me or under my direction and that the above map is a true representation thereof and shows the size and location of the property, its exterior boundaries, the location of all visible structures and dimensions of all principal buildings thereon, boundary fences, apparent easements, roadways and visible encroachments, if any."

"This survey is made for the use of the present owners of the property, and also those who purchase, mortgage, or guarantee the title thereto within one year from the date hereof."

Kenneth B. Abernathy Jr.

KENNETH B. ABERNATHY, JR.
WISCONSIN REGISTERED LAND SURVEYOR,
S-1594

Date: 3/25/02 Job No. 02.306

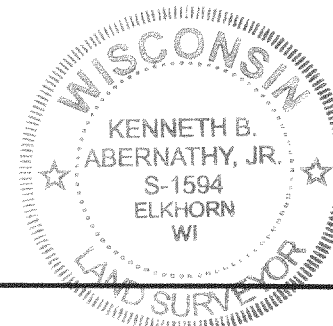

GBEA-11
GBEA-12

316-1360